

Data sheet

**OpDAT Wall-mounted distributor S 12xLC-D (ceramic, lime green)
pigtaills OM5 placed and stripped**

Page 1/3

P/N

1503287M12-E

EAN 4251394607344

2018-05-01

Illustrations



Dimensional drawing

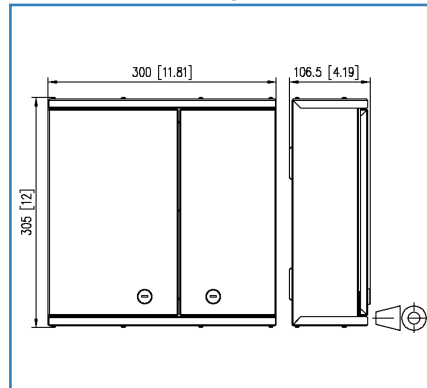

Cut-out

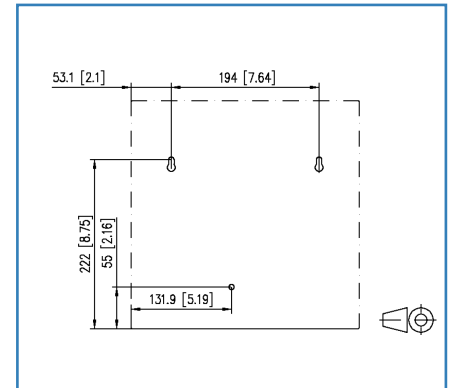

See enlarged drawings at the end of document

Product specification

- Distributor for universal use in floor cabling or as a building distribution point in the equipment room
- Equipped with LC-D adapters and LC pigtaills
- Pigtaills inserted and stripped in crimp splice holders in standard splice trays
- Unused openings are closed by blind plugs
- Wall-mount housing with two lockable swing doors, two different locks to separate network and building cabling
- Easy, space saving wall mounting
- Easy access possibilities and a secure routing of the pigtaills
- Flexible cable insertion possible from top or bottom by cable entries in different shapes (see accessories)
- Variants: size S: 305x300x107 mm or size M: 405x400x107 mm
- Variants: equipped with up to 48 LC-D adapters and up to 96 pigtaills each in blue (OS2), lime green (OM5), violet (OM4), aqua (OM3) or with LC-D APC adapters and pigtaills each in green (OS2)



Data sheet

Page 2/3

OpDAT Wall-mounted distributor S 12xLC-D (ceramic, lime green) pigtaills OM5 placed and stripped

P/N

1503287M12-E

EAN 4251394607344

2018-05-01

Technical Data

General Data	
Design	Wall-mounted distributor
Mounting style	surface mount
Transmission technology	Fiber optic
Port numbering	yes
Color	lime green
Dimensions	
Dimension (L x W x H)	106.50 x 300.00 x 305.00 mm
Dimension (L x W x H)	4.193 x 11.811 x 12.008 in.
Number of cables/ cores	24
Cable Type	pigtail(s)
Fiber class	OM5: ISO/IEC 11801/EN 50173 & IEC 60793-2-10/EN 60793-2-10 A1.a.4
Mode type of the fiber	Multimode
Fiber construction	50/125 µm
Labeling option	printed numbers

Connections/interfaces	
Connector technology interface 1	LC-D Couplers
Connector technology interface 2	LC-D Couplers
Number of ports interface 1	24
Number of ports interface 2	24
Number of equipped ports interface 1	12
Number of ports interface 2 equipped	12
Number of ports with dust protection interface 2	12
Cable access/outlet	oben oder unten

Approvals	
RoHS	compliant

The product meets the following standards	
Fibre optic connector interfaces	DIN EN 61754-20

Packing details	
Type of packaging	1 pc(s) / box
Packaging dimension (W x H x D)	330.00 x 320.00 x 125.00 mm



P | Cabling

Data sheet

OpDAT Wall-mounted distributor S 12xLC-D (ceramic, lime green) pigtails OM5 placed and stripped

Page 3/3

P/N

1503287M12-E

EAN 4251394607344

2018-05-01

Illustrations

Dimensional drawing

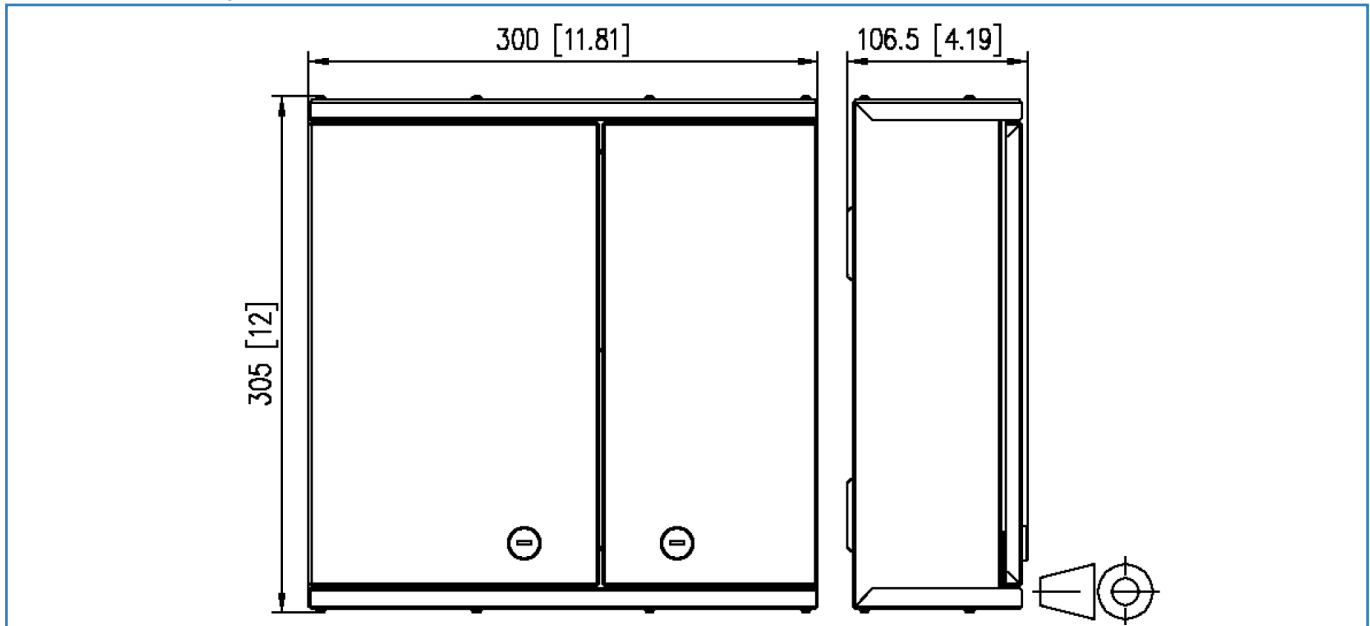

Cut-out

