

REVISION: 01 / ISSUED DATE: Oct 8th, 2019



SC CONNECTOR(SC/UPC &SC/APC)

1. DESCRIPTION

Fast Field Assembly Optical Connector is designed to manage on-site fiber connections with ease of maintenance for installers. It does not require additional practices or adhesives. It reduces connection defect rate by allowing re-assembling several times in the field.

2. FEATURES

- Fast and easy on-site installation with stability
- Eliminated field polishing
- No adhesives or electrical power required
- Reduced connection defect rate by re-assembling
- Compatible with 3.1x2mm flat cable, 3mm drop cable 2.0mm & 0.9mm cable

3. APPLICATION

- Premise environments
- Connections at the desk for LAN environments
- Patch panels
- Fiber to the Subscriber(FTTx) applications
- Equipment test leads



SC/PC



SC/APC

4. STRUCTURE

*Connector Housing

* Connector Body

* **Boot to Twist Lock

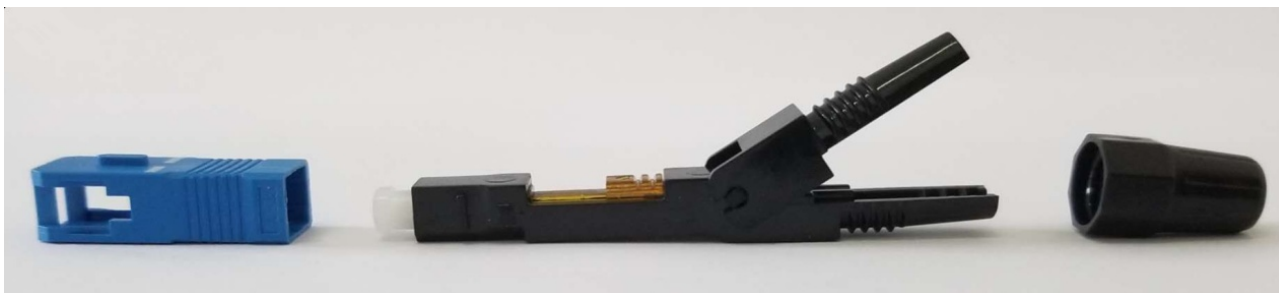

5. STRUCTURE AND DIMENSION OF THE SC FERRULE (IT'S IN ACCORDANCE TO IEC61754-4(2002-03) ED.1.2.

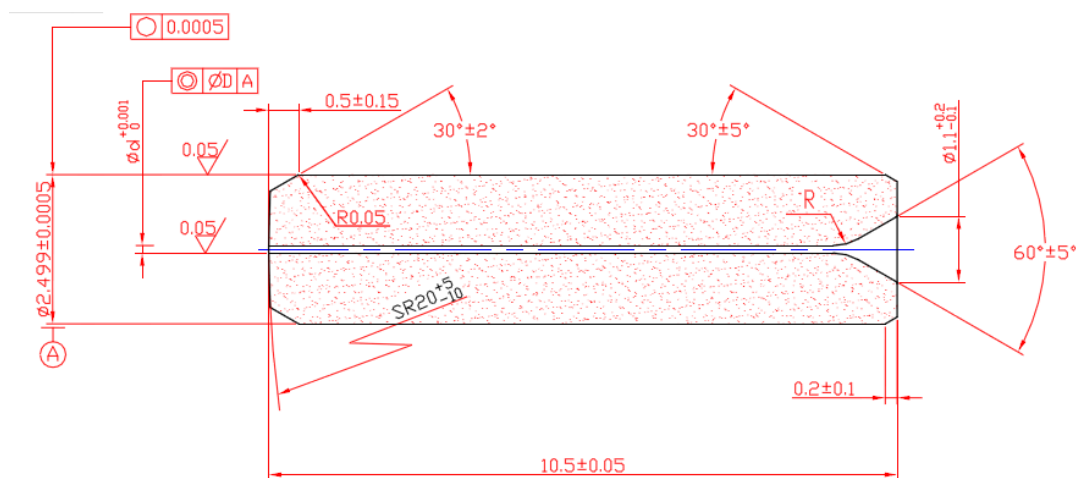

UPC Ferrule

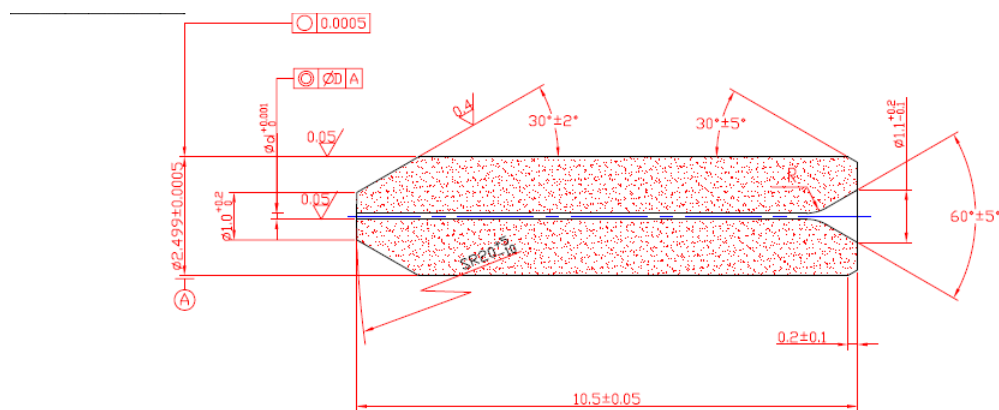

APC Ferrule

6. FERRULE SPECIFICATIONS

No	Parameter	Specification
1	Ferrule Type	Fully Zirconia-Ceramic
2	Nominal ferrule diameter for SC connector	2.5mm+0.5um
3	Fiber Concentricity	1um

The ferrule end-face geometry complies with Telcordia GR-326 specifications and is measured based on an optical interferometric measuring technique.

7. PHYSICAL SPECIFICATIONS

Item	Size(mm)	Insertion Loss	Return Loss
SS-SC/PC	59.5 x 9 x 7.3	≤0.3dB	≥50dB
SS-SC/APC	59.5 x 9 x 7.3	≤0.3dB	≥60dB

8. TECHNICAL SPECIFICATIONS

Category	Condition	Test Standards
Insertion loss		≤0.3dB
Return loss	-	SC/UPC: ≥50dB, SC/APC: ≥60dB
Vibration	Frequency range: 10-55-10Hz Amplitude: 1.52mm(±0.75mm) Cycle: 4 minutes Time: 1 hour / X.Y.Z direction	Insertion loss variation: ≤0.2dB
Tension	more than 5 kg for cable jacket	Insertion loss variation: ≤0.2dB
Impact	Free fall: 4 M	Insertion loss variation: ≤0.2dB
Repeat-connection with adaptor	1000 times	Insertion loss variation: ≤0.2dB
Temperature Cycle	Cycle: 8 hours Total: 12 cycles / 96 hours Temperature Maintenance: 1 hour *Cycle: 23 → -40 → 23 → +75 → 23	Insertion loss variation: ≤0.2dB (before, after and during the test) Return loss: ≥35dB (during the test) No Mechanical damage (including transform, damage)
Temperature / Humidity Deterioration	40 °C (relative humidity : 95%) Time: 96 hours	Insertion loss variation: ≤0.2dB (before, after and during the test) Return loss: ≥40dB (during the test) No Mechanical damage (including transform, damage)

9. STANDARD PACKAGE

#	Model	Components
1	FAOC-SS02-SC/PC	FAOC unit, Installation Guide
2	FAOC-SS02-SC/APC	FAOC unit, Installation Guide
Measurement Jig is provided for every 100 connectors or based on customer's requirements.		