

Optical outlet for FTTH client network



Specifications

- Allows entry of 2 cables by external access if the FO cable is installed in a footer;
- Allows 2 cables to enter the inside of the outlet if the FO cable is installed through the inside of the wall;
- Supports up to a maximum of 2 SC/APC FO adapters/aligners;
- Possibility of direct installation to the wall (by means of hot glue) or in a standard appliance box;
- Attractive design for installation in homes including high gloss cover;
- Unique feature of reduced size of 85x85 so that it fits perfectly when installed adjacent to the electric equipment type Legrand;
- Possibility of customization with telecom operator logo injected into the cover;
- Possibility of full customization of the cover in order to differentiate between operators;
- Ease of assembly in the optics of the installer;
- Perfect routing of the fibers without them loosening easily;
- Production made in Portugal with fast delivery times;

Included with the outlet:

- | | |
|-----------|---|
| a) 2 uni. | Screw and buches |
| b) 1 uni. | Protection splice sleeves with 45mm |
| c) 1 uni. | Plastic clamps |
| d) 1 uni. | Laser symbol sticker |
| e) 1 uni. | SC/APC outter shutter adapter green/white |
| f) 1 uni. | SC/APC Pigtail Grade B, G657A2 , 1mt |

Dimensions

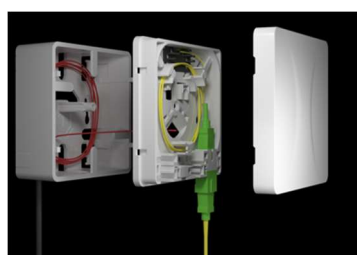
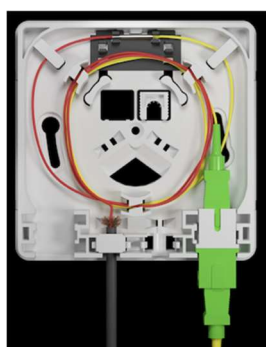
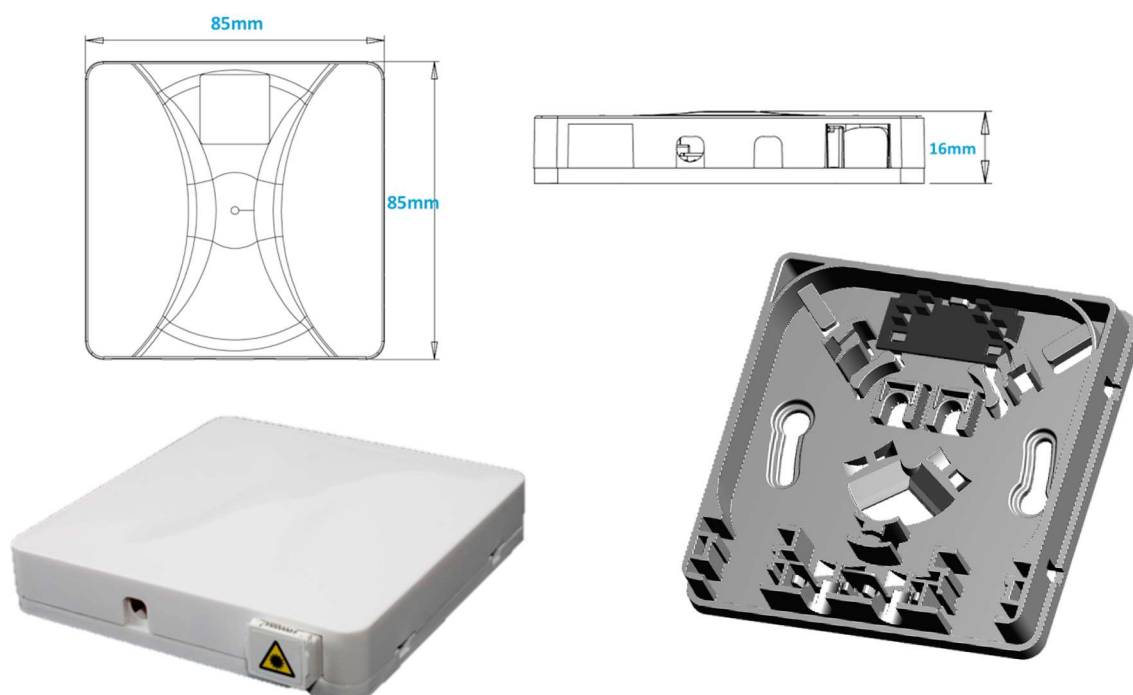

YOU SAY TELCO. WE SAY

Yeah.

Online video

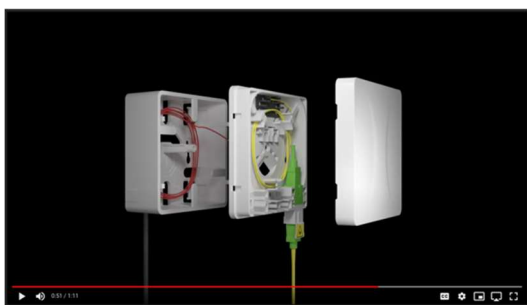

SCAN ME

<https://drive.google.com/file/d/1yF848pUkT-5P1en09FEqofP4qA5LIHE2/view>

End of Technical specifications
V16_ Proj FA112

