

# P | Cabling

## Data sheet

### OpDAT Wall-mounted distributor S 8xLC-D APC (ceramic, green) 4x4 pigtails OS2 placed and stripped

Page 1/4

P/N  
1503297608-E4  
EAN 4251394618258  
2021/02/23

## Illustrations



Dimensional drawing

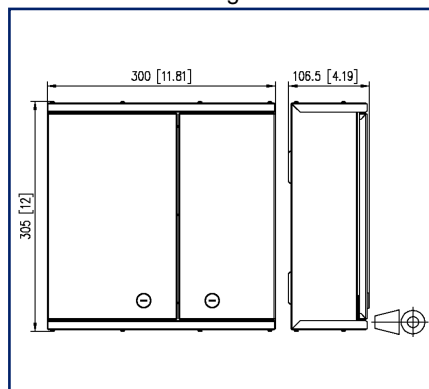

Cut-out

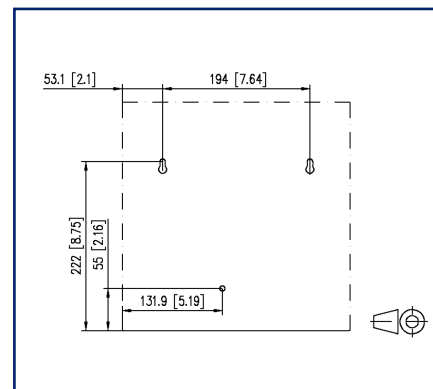

See enlarged drawings at the end of document

## Product specification

- Distributor for universal use in floor cabling or as a building distribution point in the equipment room
- Equipped with LC-D adapters and LC pigtails
- Pigtails inserted and stripped in crimp splice holders in standard splice trays
- Unused openings are closed by blind plugs
- Wall-mount housing with two lockable swing doors, two different locks to separate network and building cabling
- Easy, space saving wall mounting
- Easy access possibilities and a secure routing of the pigtails
- Four cable infeeds (scope of supply): 2x for M20/PG16, 2x for patch cords
- Variants: size S: 305x300x107 mm or size M: 405x400x107 mm
- Variants: equipped with up to 48 LC-D adapters and up to 96 pigtails each in blue (OS2), lime green (OM5), violet (OM4), aqua (OM3) or with LC-D APC adapters and pigtails each in green (OS2)

# P | Cabling

## Data sheet

Page 2/4

## OpDAT Wall-mounted distributor S 8xLC-D APC (ceramic, green) 4x4 pigtails OS2 placed and stripped

P/N

1503297608-E4

EAN 4251394618258

2021/02/23

## Technical Data

### General Data

Fields of application	Structured building cabling
Design	Splice distributor - splice
Mounting style	surface mount
Transmission technology	Fiber optic
Port numbering	yes
Color	green
Dimensions	
Dimension (L x W x H)	106 mm x 300 mm x 300 mm
Dimension (L x W x H)	4.173 in. x 11.811 in. x 11.811 in.
Number of cables/ cores	16
Cable Type	pigtail(s)
Fiber class	for OS2
Mode type of the fiber	Singlemode
Shape	APC (Angled Physical Contact)
Fiber construction	9/125 µm
Labeling option	printed numbers

### Connections/interfaces

Connector technology interface 1	LC-D Couplers
Connector technology interface 2	LC-D Couplers
Number of ports interface 1	24
Number of ports interface 2	24
Number of equipped ports interface 1	8
Number of ports interface 2 equipped	8
Number of ports with dust protection interface 2	8
Number of blind covers interface 2	16
Semi-tight buffered fiber pigtail diameter	900 mm

### Mechanical data

Cut-out	SC, LC-D, E2000
Connector type	duplex
strain relief	optional



# P | Cabling

Data sheet

Page 3/4

## OpDAT Wall-mounted distributor S 8xLC-D APC (ceramic, green) 4x4 pigtails OS2 placed and stripped

P/N

1503297608-E4

EAN 4251394618258

2021/02/23

### Technical Data

#### Materials and material properties

Material - Housing	sheet steel
Material - Front cover	sheet steel
Material - Sleeve	ceramic, slotted
Material - Coupler housing	Plastics

#### The product meets the following standards

Fibre optic connector interfaces	IEC 61754-20
Optical fibers: Indoor optical cables	
Sectional specification for class A B single-mode fibres	ISO/IEC 60793-2-50 type B.1.3 & B6_a
Optical fibers - Interconnecting devices and passive components - basic test and measuring methods	
Fibre optic interconnecting devices and passive components	IEC 61300-3-4
Fibre optic interconnecting devices and passive components	IEC 61300-3-6
Fibre optic interconnecting devices and passive components	IEC 61300-3-35
Standard colours for insulation for low-frequency cables & wires	IEC 60304
ITU-T standard	ITU-T G.657.A compatible with ITU-T G.652.D

#### Classifications

ETIM 7.0	EC001130
----------	----------

#### Packing details

Type of packaging	1 pc(s) / box
-------------------	---------------



# P | Cabling

Data sheet

Page 4/4

## OpDAT Wall-mounted distributor S 8xLC-D APC (ceramic, green) 4x4 pigtails OS2 placed and stripped

P/N

1503297608-E4

EAN 4251394618258

2021/02/23

### Illustrations

Dimensional drawing

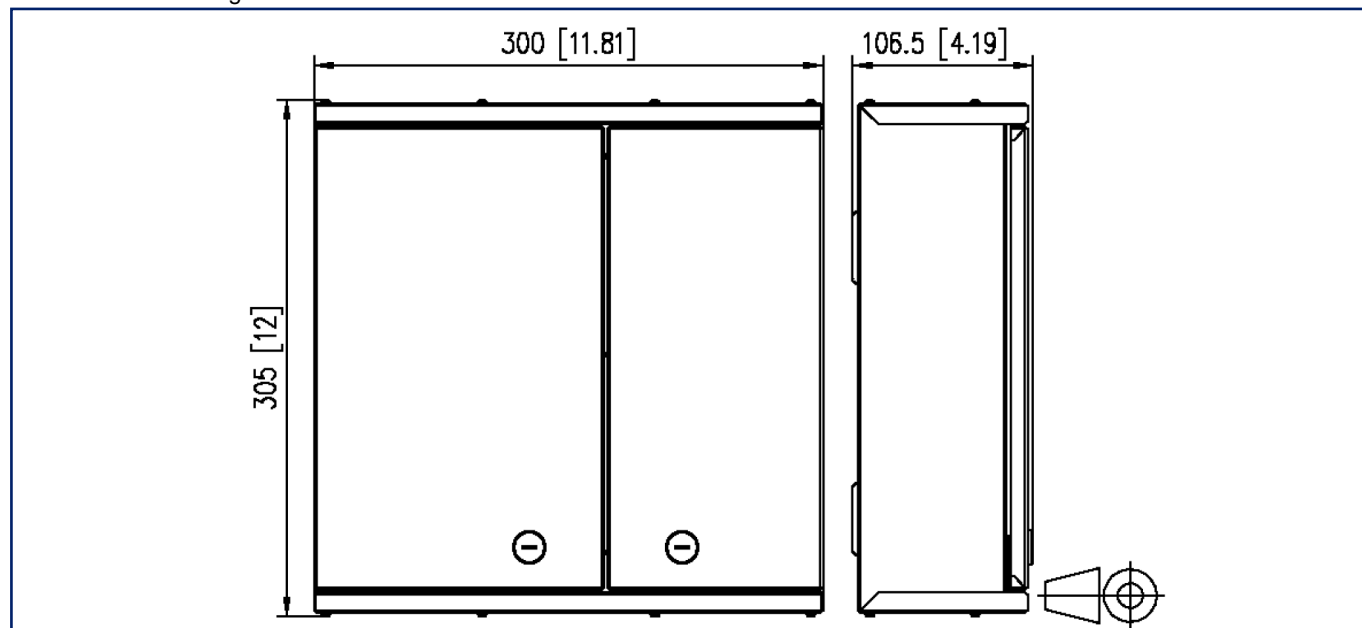

Cut-out

