

## Data sheet

**OpDAT Wall-mounted distributor S 2xLC-D APC (ceramic, green)  
pigtailes OS2 placed and stripped**

Page 1/4

P/N

1503297602-E

EAN 4251394604206

2019/08/20

Version: E

## Illustrations



Dimensional drawing

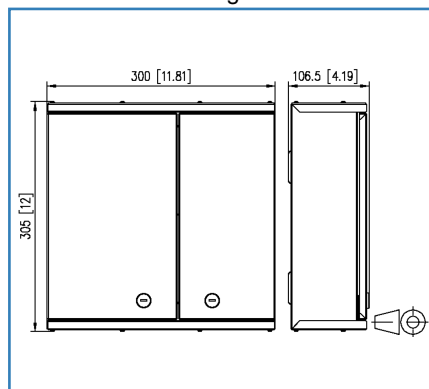

Cut-out

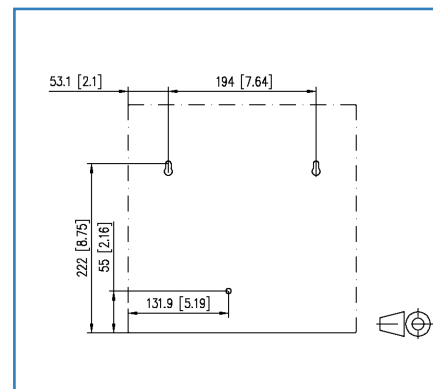

See enlarged drawings at the end of document

## Product specification

- Distributor for universal use in floor cabling or as a building distribution point in the equipment room
- Equipped with LC-D adapters and LC pigtailes
- Pigtailes inserted and stripped in crimp splice holders in standard splice trays
- Unused openings are closed by blind plugs
- Wall-mount housing with two lockable swing doors, two different locks to separate network and building cabling
- Easy, space saving wall mounting
- Easy access possibilities and a secure routing of the pigtailes
- Four cable infeeds (scope of supply): 2x for M20/PG16, 2x for patch cords
- Variants: size S: 305x300x107 mm or size M: 405x400x107 mm
- Variants: equipped with up to 48 LC-D adapters and up to 96 pigtailes each in blue (OS2), lime green (OM5), violet (OM4), aqua (OM3) or with LC-D APC adapters and pigtailes each in green (OS2)

# P | Cabling

## Data sheet

Page 2/4

## OpDAT Wall-mounted distributor S 2xLC-D APC (ceramic, green) pigtailed OS2 placed and stripped

P/N

1503297602-E

EAN 4251394604206

2019/08/20

Version: E

### Technical Data

#### General Data

Fields of application

Structured building cabling, Office  
Data center

Design

Wall-mounted distributor

Mounting style

surface mount

Transmission technology

Fiber optic

Port numbering

yes

Color

green

Dimensions

Dimension (L x W x H)

106.5 mm x 300 mm x 305 mm

Dimension (L x W x H)

4.193 in. x 11.811 in. x 12.008 in.

Number of cables/ cores

4

Cable Type

pigtail(s)

Fiber class

OS2 (IEC 60793-2-50 B1.3, B6\_a &amp; ITU-T G.657.A1, G.652.D)

Mode type of the fiber

Single mode

Shape

APC (Angled Physical Contact)

Fiber construction

9/125 µm

Labeling option

printed numbers

#### Connections/interfaces

Connector technology interface 1

LC-D Couplers

Connector technology interface 2

LC-D Couplers

Number of ports interface 1

24

Number of ports interface 2

24

Number of equipped ports interface 1

2

Number of ports interface 2 equipped

2

Number of ports with dust protection interface 2

2

Number of blind covers interface 2

22

#### Mechanical characteristics

Connector type

duplex



# P | Cabling

## Data sheet

Page 3/4

## OpDAT Wall-mounted distributor S 2xLC-D APC (ceramic, green) pigtailed OS2 placed and stripped

P/N

1503297602-E

EAN 4251394604206

2019/08/20

Version: E

## Technical Data

### Materials and material properties

RoHS compliant

### The product meets the following standards

Fibre optic connector interfaces IEC 61754-20

Optical fibers: Indoor optical cables

Sectional specification for class B single-mode fibres ISO/IEC 60793-2-50 type B.1.3 &amp; B6\_a

Optical fibers - Interconnecting devices and passive components - basic test and measuring methods

Fibre optic interconnecting devices and passive components IEC 61300-3-4

Fibre optic interconnecting devices and passive components IEC 61300-3-6

Fibre optic interconnecting devices and passive components IEC 61300-3-35

Standard colours for insulation for low-frequency cables &amp; wires IEC 60304

ITU-T standard ITU-T G.657.A1 compatible with ITU-T G.652.D

### Classifications

ETIM 7.0 EC001130

### Packing details

Type of packaging 1 pc(s) / box

Packaging dimension 330 mm x 320 mm x 125 mm

Packaging dimension 12.992 in. x 12.598 in. x 4.921 in.



# P | Cabling

## Data sheet

## OpDAT Wall-mounted distributor S 2xLC-D APC (ceramic, green) pigtails OS2 placed and stripped

Page 4/4

P/N

1503297602-E

EAN 4251394604206

2019/08/20

Version: E

## Illustrations

### Dimensional drawing

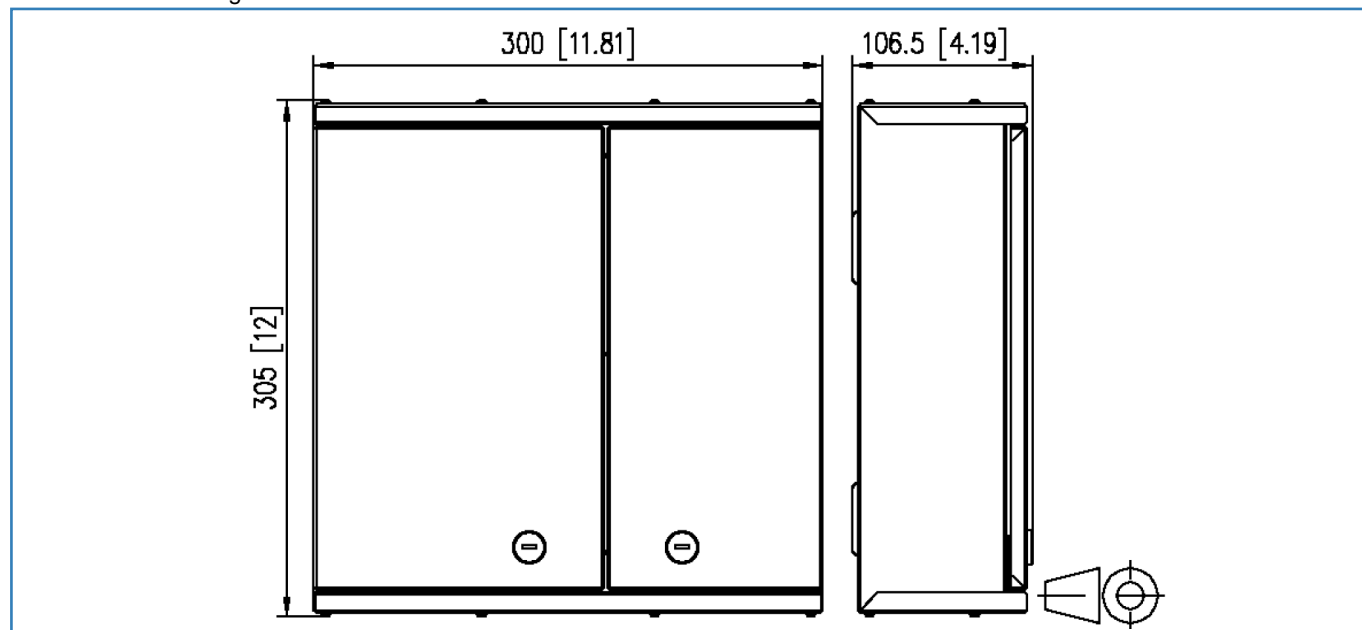

### Cut-out

